

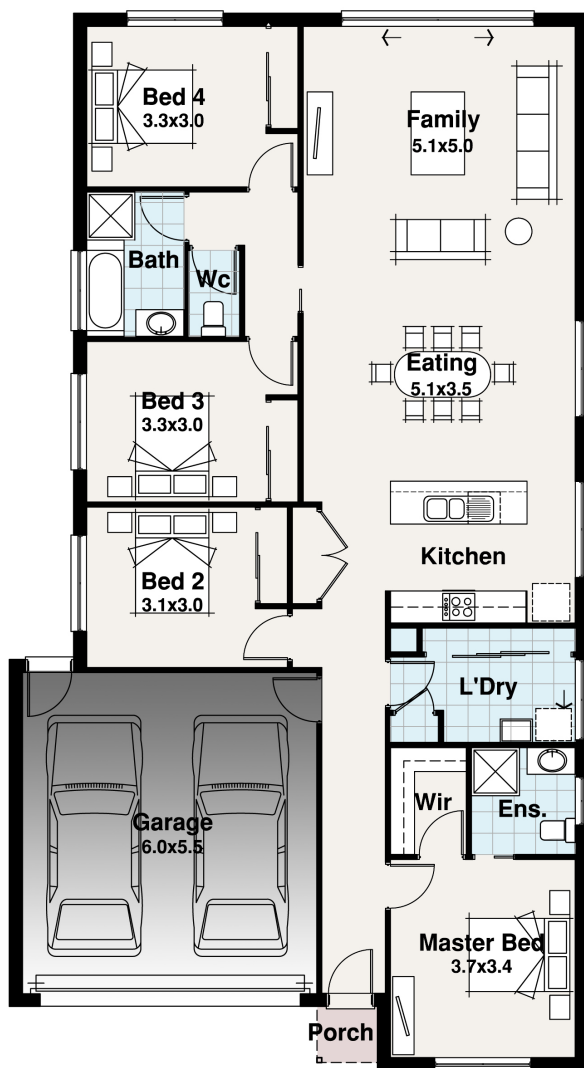

Quay West Facade Pictured

TASMAN RANGE



BLOCK 26.80m

12.00m

- 4
- 2
- 2
- 1



The Maria 1

Width 10.80m
Length 19.73m

Residence	154.32	m ²
Porch	1.18	m ²
Garage	36.04	m ²
TOTAL	191.54	m²
	20.61	sq

The Maria 1

For the big family on a tight budget. The Maria offers 4 bedrooms, full Laundry and Ensuite / Walk-in-robe just under 160m².

The smart Galley Kitchen overlooks the generous open Meals and Family areas. Designed to fit 12m wide blocks, The Maria offers a large opportunity for matching up with narrow blocks.